



Medford Historical Society
circa 1966
Newsletter

Mill Phone: 609-654-7767

www.MedfordHistory.org

Kirby's Mill, 275 Church Road, PO Box 362, Medford, New Jersey 08055

Cross keys One-Room Schoolhouse, 55 Mill Street, Medford, New Jersey 08055

November 2023

Haines/Tomlinson House Open for Dicken's Festival

The Medford Historical Society is proud to announce the recent acquisition of 51 Union Street, known to many as the "Haines House" for its original owner Jonathan Haines, or the "Tomlinson House" for the late Eph Tomlinson and his family who lived there. This acquisition was made possible with the help of Medford Township and is located in front of the new Medford Township building. The home is believed to be the oldest in Medford Village and an interesting link to Medford's past.

Originally built in 1760 by Jonathan Haines, the house was later added to by his grandson (also Jonathan) in 1820. In those days the home's backdrop was a much larger homestead, and many of the surrounding homes presently standing on Union Street to the east and west were home of Haines' children and descendants. The brick home at 51 Union Street remained in the Haines family until 1917.

In 1950, Ephraim Tomlinson II and his wife Alice purchased the home to raise their young family. Eph was a key leader and giving friend to the community as many still recall. A prominent attorney, bookkeeper, and advisor to many in the community, as well as township solicitor for 19 years and mayor for 15, the home was warmly frequented by many in the community from the 1950s through the early 2000s. Today many long-term residents fondly recall freely using the Tomlinson's big yard for neighborhood sports matches, frequenting the house for business matters, and Alice always at the ready to offer a glass of water or lemonade. Many stories of Eph that we look forward to sharing illustrate values of kindness, perseverance, hard work, and community spirit that strengthened and enriched the community beyond his years and can be a positive example to future generations.

Looking forward, we are excited for this opportunity to share the Tomlinson House as an accessible place to share the values, history, and community strengths that led Medford to become the place that it is today, and to inspire future generations to contribute as active community members to continue preserving and developing Medford history into the future. It will take time and volunteers to work on the property and new museum installations in the coming years; however, we're excited to open a portion of the home to the public for the first time from 4:30PM – 9:30PM on Saturday, December 2 during Medford's annual Dicken's Festival.



Medford Historical Society Officers 2023 - 2024 Fiscal Year

President	Tomlinson/Haines House	Kirby's Village	Secretary/Apple Festival	Cross Keys School-House	Newsletter
Richard Bucko 609-315-6266 rbucko@comcast.net	Michael Gallagher 856-296-4060 mgalla48@gmail.com	John Hines 609-531-1825 jxhines15@gmail.com	Kelly Maguire 609-654-8483 maguirefamily1@verizon.net	Pat Alvino 609-410-6950 talvino12@comcast.net	Dennis McDonald 609-353-7502 medfordhistry@gmail.com

TRUSTEES EXPIRES 2025 Rick Young, Patricia Alvino, William Pflug, Carol Milich, Dennis McDonald
 EXPIRES 2024 Edmund Gager, Tom Gerber, John Hines, Douglas Donor, Jeanne Woodford
 EXPIRES 2023 Kelly Maguire, Libby Zimbleman, Carol Douglas, Michael Gallagher, Peter Perno

President's Corner

As we look back on recent months, we see success and good times in many ways. At the September Flea Market many vintage items, and some not-so, changed hands. The morning of the Apple Festival on October 12 was active, with the afternoon hampered by unpleasant weather. Never-the-less it was still a good day enjoyed by many.

The Apple Festival is normally the main source of funds for the Historical Society to maintain our historic buildings. Medford is a special and varied community made up of farms, woodlands, housing developments and historic sites. Kirby's Mill, the Cross Keys Schoolhouse and the recently acquired Haines-Tomlinson House at 51 Union Street in the "Village", are each maintained by the Medford Historical Society. They require attention, just as your property does. The Trustees and Friends of the Medford Historical Society care a great deal about saving and sharing the historic legacy of the community. Everyone who enjoys history and Medford has the opportunity to protect and enhance this historic legacy. Donations to support this effort may be targeted to the general fund or specific projects (such as painting of the Mill water wheel, repair of windows in the Schoolhouse or renovation of 51 Union St.).

Donations may be made to:

Medford Historical Society 275 Church Road. Medford, NJ 08055

There have been two general meetings and speakers this fall. On October 6 the One-Room School House was featured in a talk by Maureen Leach, "Flag Over the School House", concerning the importance of these schools to the growth of our country. On November 2, Dr Greg Lattanzi, Curator and Archeologist at the NJ Museum of History spoke on the indigenous people of this area. He also assessed the collection at the museum in Kirby's Mill, which includes many local artifacts. Several attendees brought their own found items to be evaluated.

In December there will be three events held by MHS. On Saturday, December 2 there will be an Open House at the Cross Keys Schoolhouse on Mill Street from Noon - 3:00. SANTA will be there. Followed later that day, will be the inaugural Open House at our new property at 51 Union Street, the Haines – Tomlinson House. This will be a good opportunity visit this historic 1760 property that is the "Anchor to Historic Medford Village".

Our last event of the year will be a CONCERT at the Friends Meeting at 14 Union Street at 7:00 p.m. on Saturday, December 16. Well known singer, Charlie Zahm, will present songs of the season in this beautiful setting. There is no charge for this event sponsored by MHS, but donations will be accepted and appreciated.

We wish you a gracious and peaceful holiday season – from the

Medford Historical Society RB

LAKE COTOXEN

The recreation plan that never happened

By Tom Rende



There were two land development projects proposed in Medford in 1924 one being Medford Lakes, which many people are familiar with and the other that is virtually unknown. Both of these land development projects offered similar characteristics, small lots with many bordering lake water. The Medford Lakes project prospered while the other known as Cotoxen Park "Health Resort at Lake Cotoxen" failed to gather enough public interest.

The South Jersey Building Corporation, developers from Camden, New Jersey headed by C.T. Husson had the Lake Cotoxen development plan established and approved by the Township of Medford and Burlington County in 1924. The original Blueprint was done by Henry Lippincott, licensed surveyor, was approved and signed by Frank A. Braddock, Medford chairman and Herbert J. Bowker, Medford clerk.

Advertising booklets were produced and made available to the public. The booklets emphasized the heavy foliage and abundance of maple, cedar, pine, ash, birch, spruce. Walnut and hickory trees made even midsummer's sun hardly never felt. They described the picturesque scenes as imaginable and the whole atmosphere as untouched nature.

The theme of the area was historically presented, emphasizing the first settlers that inhabited this area were the Lenape tribe of the Algonquin Indians known for their hospitality. This theme was portrayed on the booklets showing an Indian Chief and "The Happy Hunting Ground" cliché.

They advertised the many pleasures that would be available: swimming, boating, fishing, hiking, campfires, gunning, trapping. In addition, they were going to provide tennis courts, canoes, bowling alleys, bath lockers and a refreshment parlor with a dance floor.

The goal was to sell the building lots. The lots were very small and of various sizes, some water front while others were inland. Some lots had trees; others were clear. The variation of each lot caused a substantial price range. They did mention that it was possible to buy a lot for as low as \$ 150.00. In reviewing the development plan, it would seem you would need at least two lots to construct even a modest size vacation cottage.

The development plan was not set up for year-round living but for a second home get away. That was not mentioned in the booklet, but seemed understood.

I feel the main differences between Medford Lakes plan being successful and the Lake Cotoxen plan failing is that Medford Lakes plan provided for residents to live year-round. In addition, the Medford Lakes plan had multiple lakes while Lake Cotoxen was just one lake.

But it is interesting to look back and see what people were trying to do with the community. Looking at this area today, I am very pleased that it did not catch on. Even though the land is still divided as per the 1924 approved design, all the property owners have built their homes on several lots. For example, my property that has the 1784 "Miller House" on it is made up of seventeen building lots. By using several lots to build their homes, the property owners were able to construct substantial size houses that make living at the Lake Cotoxen/Kirby's Mill area very pleasing

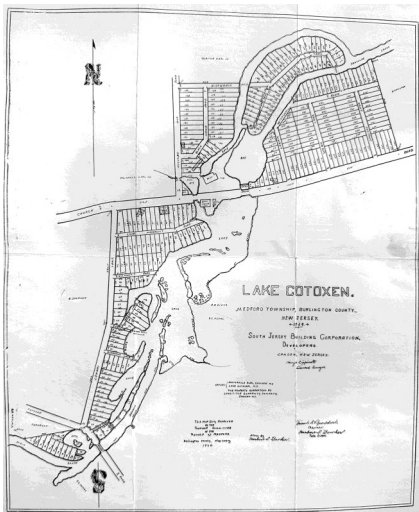

<i>View of Southern part of Lake looking West.</i>	<i>A part of Haines Creek above the Lake, showing one of the smaller islands.</i>	<i>Entering Lake Cotoxen, looking East, showing bridge. The shadow of building on right is the Lakeside office.</i>
<p>Location LAKE COTOXEN is just outside Medford, 20 miles from Phila. directly East. It is 6 miles South of Mt. Holly, and 13 miles from Burlington.</p>	<p>Pleasures In addition to swimming and boating, there is fine fishing at LAKE COTOXEN. Pike, Catfish, and some trout and perch are caught. The woods with their narrow paths—the "ol' swimmin' holes"—are unusually enjoyable novelties. When the present developments are finished, there will be tennis courts, canoes, bath lockers, and a refreshment parlor with a modern dance floor.</p>	<p>Prices and Terms Prices of the various lots range according to their sizes and locations. While no definite arrangements have been made for partial payments, terms will be arranged to suit the convenience of desirable purchasers.</p>
<p>Environment The landscape at the Lake is truly wonderful. Heavy foliage on trees of maple, cedar, pine, ash, birch and spruce, to say nothing of walnut and hickory,—make road, field and stream alike hot leafy bowers where the full force of even midsummer's sun is never felt.</p>	<p>Arrangement of Lots The lots have been arranged in varying sizes, and shapes, some facing on the Lake itself, others inland. Some are heavily wooded, others almost entirely clear of growth. With the exception of the roadways to be laid out, no changes will be made in the present appearance of the tract.</p>	<p>Building Restrictions No hard and fast rules have been made regarding building restrictions. Precautions will be taken to protect the resale value of any lot or building.</p>
<p>The winding stream above and below the Lake is one of the most picturesque scenes imaginable. In fact, the whole atmosphere is one of untouched Nature.</p>		<p>Conveniences The water power from the dam will provide sufficient electric current for ordinary lighting purposes. This dam will also give running water, thus permitting bath, toilet, etc.</p>

Authorship of the Pledge of Allegiance Still Questionable

On October the fifth, the Medford Historical Society held its monthly gathering at the Friends Meeting House, Union Street in Medford, NJ. Historian and lawyer, Maureen O'Connor Leach, gave the history of the inclusion of the flag in the teaching of patriotism in a one-room school-house. She also speculated on the origins of the Pledge of Allegiance. According to Mrs. Leach, several possibilities abound as to who actually wrote the pledge. Though she has her own opinion, she left it up to the listeners to make up their own minds.

The Medford Historical Society would like to thank Maureen for her thought-provoking presentation and for donating her speaking honorarium back to the Medford Historical Society. - Pat Alvino



Historic Trees in Medford

We often do not consider trees as a connection to our past, but they may be one of the most historic reminders of what and who came before us. Some trees in Medford began before the arrival of European settlers before 1700. We all know the importance of trees to our air, wildlife, stormwater management, landscaping, and our quality of life.

A local example of an effort to save an historic 300-year-old Red Oak tree, just off Skeet Road, is slated for having a critical branch removed by PSEG to make way for an electric line upgrade. This Red Oak is one of the largest and oldest trees in the area having been present before the United States was founded. Professional opinion indicates that this branch removal will severely compromise its health and could tip the scale towards its demise. This beautiful and unique specimen is a living, feeling, breathing organism that provides essential environmental benefits. To its credit, PSE&G listens to historic and environmental concerns and may be able to find a way to detour around the tree.

Our state of New Jersey maintains records for the biggest trees. If you would like to learn more, or register one of your own "big" trees, you may do so at: <https://www.nj.gov/dep/parksandforests/forest/bigtree>

Nathan Ihlenfeld, *LandSculpture, LLC*





44th Annual Apple Festival – Presented by ShopRite of Medford

Thank you to all our volunteers who helped make it another success in spite of the damp weather that day!

We are looking forward to next year. Hope to see you there

The Medford Historical Society Welcomes
Everyone Naughty or Nice!

Santa at the Schoolhouse

Saturday, December 2nd Noon-3:00PM

Stop by before the Dickens Festival

PICTURE THIS! A cozy, warm potbellied stove, the schoolhouse adorned with 19th century holiday decorations and, of course, a visit with Santa. **FREE** admission.

Take your own photos



Historic Cross Keys Schoolhouse
55 Mill Street, Medford, NJ
(next to entrance to Memorial Middle School)



The Celtic Christmas

CONCERT!

CHARLIE ZAHM

HOSTED BY
THE MEDFORD HISTORICAL SOCIETY

7:00 PM, DECEMBER 16TH
THE FRIENDS MEETING,
14 UNION ST., MEDFORD

FREE ADMISSION

donations to the Medford Historical Society appreciated

Folk songs new and old, plus beautiful
songs of the season---brought to life as only
Charlie can. All our welcome!